

PQI CORE

TYPE	FIG.	Dimensions(mm)							
		A	B	C	D	E	F	G	H
PQI20.5/13.1/14	1	20.5±0.4	10.1±0.1	14.0±0.4	8.8±0.2	18.0±0.4	7.15±0.15	12min	2.95±0.15
PQI20/12/14	2	20.5±0.4	9.9±0.1	14.0±0.4	8.8±0.2	18.0±0.4	7.2±0.15	12min	21.3±0.4
PQI26.5/16.7/19	1	26.5±0.45	12.5+0/-0.25	19.0±0.45	12.0±0.2	22.5±0.45	8.05±0.15	15.5min	26.6±0.45
PQI26/15/19	2	26.5±0.45	12.5+0/-0.25	19.0±0.45	12.0±0.2	22.5±0.45	8.05±0.15	15.5min	27.3±0.4
PQI32/18.5/22	1	32.0±0.5	14.0±0.15	22.0±0.5	13.4±0.3	27.5±0.5	9.5±0.15	19min	
PQI32/20.4/22	1	32.0±0.5	15.3±0.2	22.0±0.5	13.45±0.3	27.5±0.5	10.7±0.2	19min	
PQI35.1/20/26	1	35.1±0.6	15.0±0.15	26.0±0.5	14.35±0.3	32.0±0.5	10.125±0.15	23.5min	
PQI35.1/27/26	1	35.1±0.6	22.0±0.2	26.0±0.5	14.35±0.3	32.0±0.5	17.0±0.2	23.5min	
PQI40.5/21/27.9	1	40.0+1.4/-0.4	16.0±0.2	28.0+0.45/-0.6	15.0+0/-0.6	36.4min	11.0±0.2	27.2min	40.0+1.4/-0.4
PQI40/20/28	1	40.0+1.4/-0.4	15.13±0.12	28.0+0.45/-0.6	15.0+0/-0.6	36.4min	9.98±0.15	27.2min	40.0+1.4/-0.4
PQI50/28/32	1	50.0±0.7	20.8±0.2	32.0±0.6	20.0±0.35	44.0±0.7	13.65±0.2	32min	50.0±0.7

PQI CORE

FIG.1

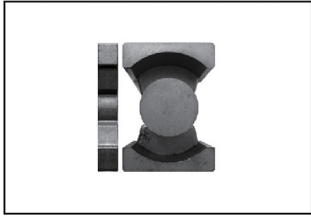
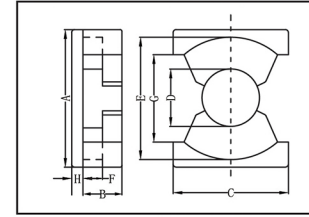
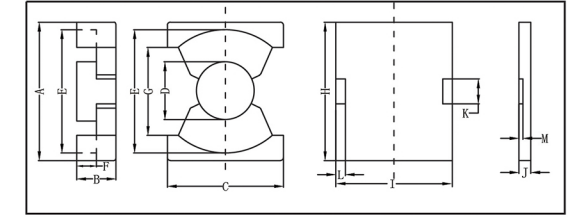

FIG.2

Dimensions(mm)					Cl (mm ²)	Ae (mm ²)	Le (mm)	Ve (mm ³)	AL±25%(nH/N ²)			Weight g/PRS
I	J	K	L	M					FW40	FW44	FW95	
					0.51	60.94	31.24	1903.5	3600	3700	4500	11.50
14.0±0.3	2.1±0.2	6.5±0.2	2.5±0.2	0.8±0.2	0.53	56.59	30.25	1712	2950	3050	3700	10.20
4.35±0.1	19.0±0.45				0.32	119.81	38.02	4555.2	6000	6200	7600	25.50
19.0±0.3	2.8±0.2		3.5±0.2	1.0±0.2	0.45	120.14	38.08	4574.9	5600	5800	7200	24.60
4.5±0.1	32.0±0.5	6.5±0.2	19min		0.3	162.77	49.54	8062.8	6100	6300	7900	39.40
5.1±0.2	32.0±0.5	22.0±0.5			0.31	167.95	52.79	8866.1	5900	6100	7700	44.80
5.0±0.20		22.0±0.3			0.3	183.51	55.5	10185.2	6500	6700	8500	47.00
5.0±0.20					0.38	184.21	70.72	13027	5300	5500	7100	61.92
5.0±0.1	28+0.45/-0.4				0.32	196.45	62.78	12333.5	6200	6400	8100	60.80
5.0±0.1	28+0.45/-0.4		6.25±0.2		0.42	198.53	82.68	16414.5	4900	5100	6600	88.60
6.72±0.15	32.0±0.6	29.0±1.0			0.22	318.00	70.00	22248	10500	10900	13500	134.50